



460 Southport Commerce Blvd.  
 Spartanburg SC 29306  
 Phone: 864-574-6004  
 Fax: 864-574-6005  
 www.ojedausa.com  
 sales@ojedausa.com

Project: \_\_\_\_\_  
 Model #: \_\_\_\_\_  
 Item #: \_\_\_\_\_ Qty: \_\_\_\_\_  
 Approval: \_\_\_\_\_

# REFRIGERATED DELI CASE

# RDCH-5



### ELECTRONIC CONTROL

The intelligent temperature control is programmed to ensure the correct operation of the equipment and maintain products at an optimum temperature.

### R-290 REFRIGERANT

Equipped with R-290 refrigerant, an eco-friendly alternative that meets the EPA's environmental impact regulations.

### LED LIGHTING

LED lighting lasts longer than fluorescent lighting, it reducing energy consumption, which generates minimal heat. All of this makes LED lighting great for the environment.

### HOT GAS EVAPORATION

Hot gas heated drain pan for condensate evaporation that eliminates the need of floor drains or electric heaters.

### OPERATING TEMPERATURE

33°F to 38°F

### CUSTOM GRAPHICS

Standard color: black

| Dimensions |      |      | Crated Dimensions |      |      | Shelves | HP   | Voltage               | NEMA config | Amps | Crated Weight                        |   |         |
|------------|------|------|-------------------|------|------|---------|------|-----------------------|-------------|------|--------------------------------------|---|---------|
|            | W    | D    | H                 |      | W    | D       | H    | 2                     | 1/4+        | 120  | 5-15P                                | 5 | 571 lbs |
| (in)       | 60.2 | 33.6 | 50                | (in) | 67.2 | 40      | 58.3 | Net Capacity (cf): 17 |             |      | Energy Consumption: 6.8 kw-hr/24 hrs |   |         |
| (mm)       | 1530 | 854  | 1269              | (mm) | 1705 | 1015    | 1480 |                       |             |      |                                      |   |         |

\*Inches rounded up one decimal place \*Specifics may change without notification



## CABINET CONSTRUCTION

- High-density, CFC-Free, polyurethane insulation
- Curved glass
- Exterior: galvanized metal cabinet with powder coated painted surface
- Interior: easy to clean pre-painted steel
- Stainless steel bottom
- Sliding glass doors

## SHELVING

- Adjustable shelves
- 54.3" width x 15" depth (1379 mm x 380 mm)
- Weight capacity per shelf 176.3 lbs

## OPERATING CONDITIONS

- The unit is best suited for an environment where temperatures remain below 75°F and humidity does not exceed 55%.
- Areas with direct sunlight should also be avoided.

## REFRIGERATION

- Maintenance free condenser
- Reverse cycle defrost system
- Hot gas heated pan for condensate evaporation
- R-290 refrigerant

## OPTIONS

- Interior mirrored ends
- Cutting board top

## WARRANTY

- 3 year parts and labor warranty
- 5 year compressor

## LIGHTING

- Horizontal LED lighting
- On/off light switch

## 4 AMP ACCESSORY RECEPTACLE



## LED LIGHTING

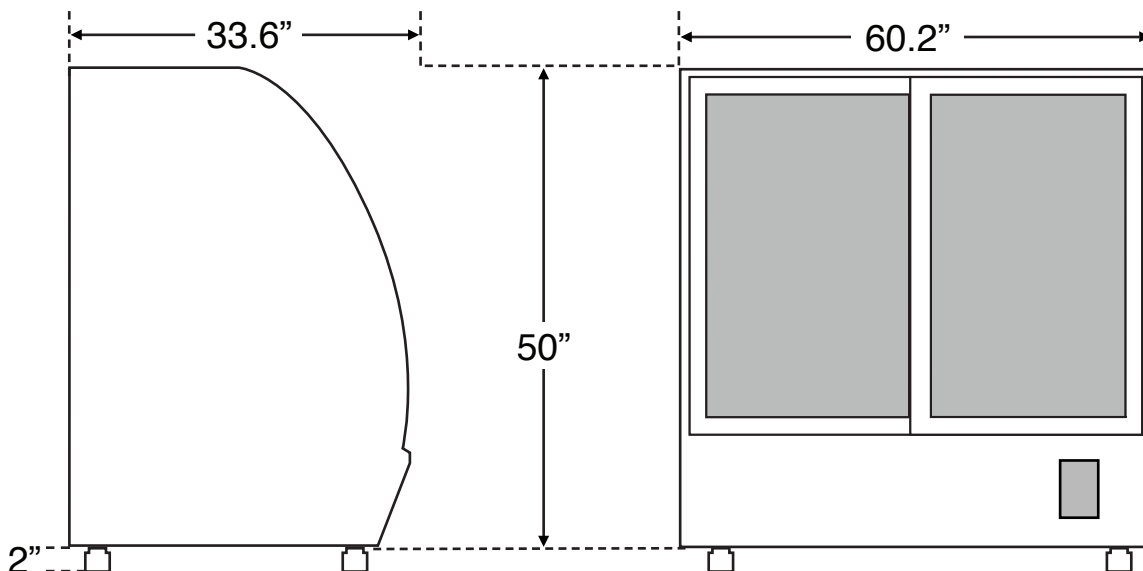

\*Specifics may change without notification

